

The two Additions of 29<sup>ac</sup> & 8<sup>7/16</sup> ac described by B & C were Survey'd in Pursuance of a 50<sup>ac</sup> warrant Bearing Date 21<sup>st</sup> December 1752

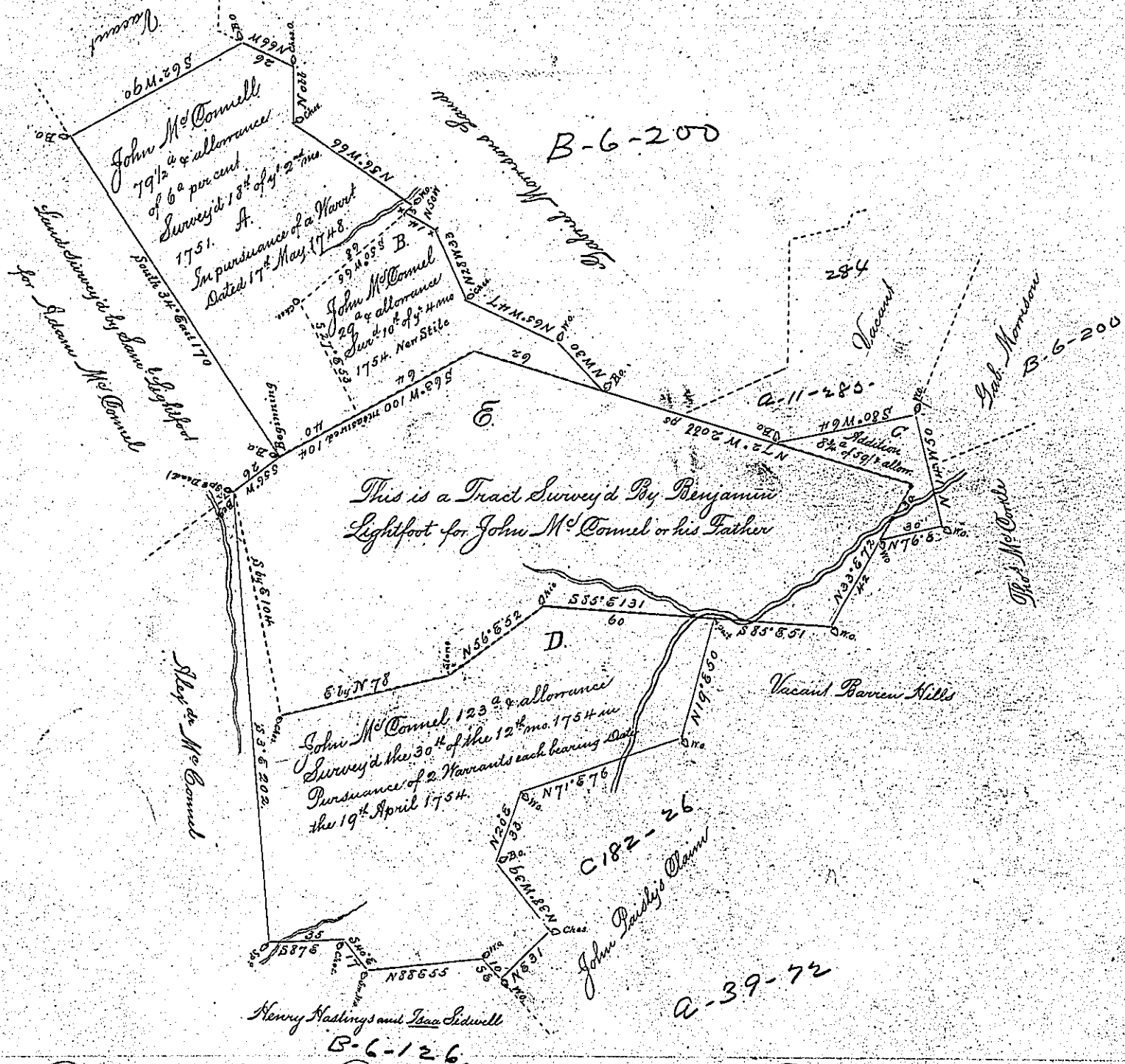

This is a Tract Survey'd By Benjamin Lightfoot for John M<sup>c</sup>Connell or his Father

The Land Described by this Draught is Situate on the Branches of Octoraro Creek in Colerain Township Lancaster County

The four Pieces Described by A, B, C, D, were respectively Survey'd by Warrants Granted in the Name of J<sup>no</sup> M<sup>c</sup>Connell above mentioned for the use of himself & his Brother Daniel

The Original Tract marked O was Survey'd by Sam<sup>l</sup> or Benja<sup>n</sup> Lightfoot

By George Churchman D S

IN TESTIMONY that the above is a copy of the original remaining on file in the Department of Internal Affairs of Pennsylvania, made conformably to an Act of Assembly approved the 16th day of February, 1833, I have hereunto set my Hand and caused the Seal of said Department to be affixed at Harrisburg, this first day of February 1898.

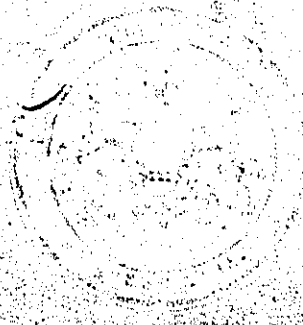

James W. Fatta  
Secretary of Internal Affairs